

A

B

C

D

E

Thermal protection to switch off - thermistors 155°C  
 Color RAL 5009  
 Painting plan 207A  
 Mounting B3T

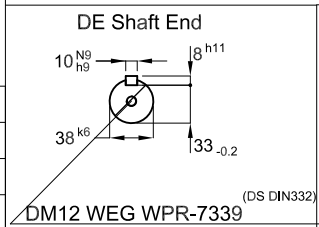

5.5 kW 04 Poles 50 Hz A

ECM	LOC	SUMMARY OF MODIFICATIONS	HYBRISUSER	EXECUTED	CHECKED	RELEASED	DATE	VER
EXECUTED	HYBRISUSER	THREE PH. MOTOR W22 IE3 FRAME 132S IP55 TEFC						00
CHECKED								
RELEASED								
REL. DATE								

**PREVIEW**  
 WDD | 00  
 SHEET /

