

A

B

C

D

E

Thermal protection to switch off - thermistors 155°C
Color RAL 5009
Painting plan 207A
Mounting B3T

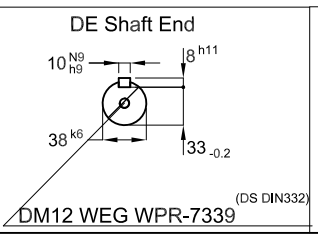

5.5 kW 02 Poles 50 Hz						A			
HYBRISUSER						00			
ECM	LOC	SUMMARY OF MODIFICATIONS			EXECUTED	CHECKED	RELEASED	DATE	VER
EXECUTED	HYBRISUSER	THREE PH. MOTOR W22 IE3			PREVIEW				
CHECKED		FRAME 132S IP55 TEFC			WDD		00		
RELEASED					SHEET		/		
REL. DATE									

