

Main terminal box  
2x M25x1.5  
+  
M20x1.5  
Grounding 0.5-6 mm<sup>2</sup> / 20-10 AWG

D			2.2 kW 04 Poles 50 Hz		A
E	Sealing - oil seal ring				
	Bearing cap				
	Thermal protection to switch off - thermistors 155°C				
	Color RAL 5009				
	Painting plan 207A				
	Mounting B5T				

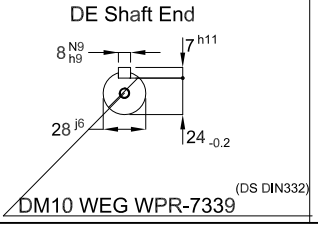

ECM	LOC	SUMMARY OF MODIFICATIONS	HYBRISUSER						00
EXECUTED	HYBRISUSER	THREE PH. MOTOR W22 IE3	EXECUTED	CHECKED	RELEASED	DATE	VER		
CHECKED		FRAME 100L IP55 TEFC							
RELEASED									
REL. DATE									

PREVIEW  
WDD | 00  
SHEET /