

Thermal protection to switch off - thermistors 155°C
 Color RAL 5009
 Painting plan 207A
 Mounting NEMA F-3
 Mounting B3T

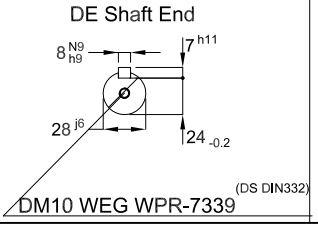

2.2 kW 04 Poles 50 Hz										A	
HYBRISUSER										00	
ECM	LOC	SUMMARY OF MODIFICATIONS					EXECUTED	CHECKED	RELEASED	DATE	VER
EXECUTED	HYBRISUSER	THREE PH. MOTOR W22 IE3					PREVIEW		WDD 00		
CHECKED		FRAME 100L IP55 TEFC					SHEET		/		
RELEASED											
REL. DATE											

Dimensions in mm

A3

