

A

B

C

D

E

Thermal protection to switch off - thermistors 155°C
 Color RAL 5009
 Painting plan 207A
 Mounting B5T

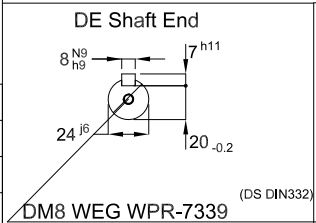

1.5 kW 02 Poles 50 Hz

A

ECM LOC

SUMMARY OF MODIFICATIONS

HYBRISUSER

00

EXECUTED

HYBRISUSER

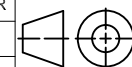

THREE PH. MOTOR W22 IE3
 FRAME 90S IP55 TEFC

PREVIEW

CHECKED

RELEASED

REL. DATE

WDD 00

SHEET /



Dimensions in mm

A3