

Sealing - oil seal ring
Bearing cap
Color RAL 5009
Painting plan 207A
Mounting B5T

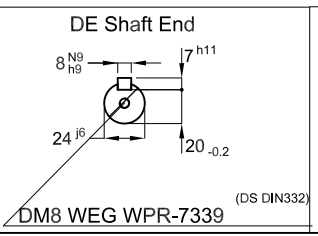

1.5 kW 04 Poles 50 Hz

ECM	LOC		THREE PH. MOTOR W22 IE3	PREVIEW WDD 00 SHEET /	
EXECUTED	HYBRISUSER		FRAME 90L IP55 TEFC		
CHECKED					
RELEASED					
REL. DATE					
				HYBRISUSER	00
			SUMMARY OF MODIFICATIONS	EXECUTED	CHECKED
				RELEASED	DATE
				VER	

Dimensions in mm

A3