

A

B

C

D

E

Thermal protection to switch off - thermistors 155°C
 Color RAL 5009
 Painting plan 207A
 Mounting B3T

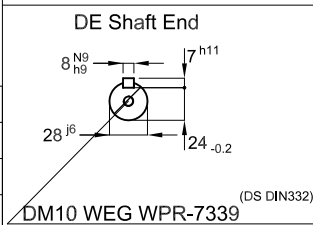

4 kW 02 Poles 50 Hz A

| ECM | LOC | SUMMARY OF MODIFICATIONS | EXECUTED | CHECKED | RELEASED | DATE | VER |
|-----------|------------|--------------------------|----------|---------|----------|------|-----|
| EXECUTED | HYBRISUSER | THREE PH. MOTOR W22 IE3 | | | | | |
| CHECKED | | FRAME 112M IP55 TEFC | | | | | |
| RELEASED | | | | | | | |
| REL. DATE | | | | | | | |

HYBRISUSER 00

PREVIEW

WDD | 00

SHEET /

